

Lifting station *Aqualift F Mono* 50 liter tank volume

for free-standing installation in frost-free rooms



CE EN 12050-1

Tank volume: 50 liters
Pump volume: 20 liters

Polyethylene storage chamber with clean-out opening. With sound-absorbing underlay mat (10 mm thick). Connection for inlet \varnothing 110 and ventilation \varnothing 75, connection coupling for manual diaphragm pump \varnothing 32 mm.

Pump

SPF pump for wastewater with or without sewage, pressure sensor controlled with multi-vane impeller. Open channel passage 40 mm. Pump is rated submersible (IP 68), pump cable length 5 m. Outlet with integrated non-return valve, connection coupling \varnothing 110 with elastic hose section.

Pressure outlet:

vertical \varnothing 110 without closure valve or horizontal \varnothing 110 with closure valve

Comfort control unit

with mains power ON / OFF switch and multilingual digital display (EN, DE, FR, IT, PL, NL) showing current operational status, settings and logbook; control unit is splash proof (IP 54), wall mounted, voltage 230 / 400 V 50 Hz. With potential-free contact.



Illustration shows Art. no. 28 646-C

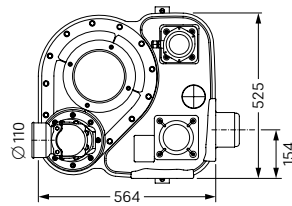
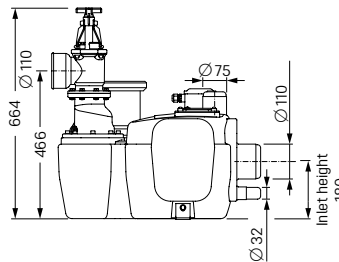

Illustration shows Art. no. 28 648-C

Mono version with one pump

SPF pump	Voltage	Art. no.
Without closure valve		
1400-S3	230 V	28 646-C
1500-S3	400 V	28 751
3000-S3	400 V	28 752
With closure valve		
1400-S3	230 V	28 648-C
1500-S3	400 V	28 753
3000-S3	400 V	28 754

- **Accessories:** page 134 – 141
- **Note:** Also available in 60 Hz / 400 V page 108

* according to EN 12056-4

Pumping capacity

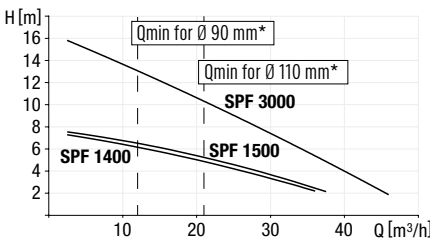

Pump type	Input Power (P1)	Power (P2)	Voltage	Frequency	Amperage	Fuses surge-proof	Cable connections 5 m Length	Media temperature	Weight (Pump)	Protection	RPM	Pumping capacity	Pumping height
SPF 1400-S3-50%*	1.6 kW	1.1 kW	230 V	50 Hz	7.3 A	16 A	3 × 1.0 mm ²	40°C	23 kg	IP 68	1.370	38 m ³ /h	7 m
SPF 1500-S3-50%*	1.4 kW	1.1 kW	400 V	50 Hz	2.7 A	3 × 16 A	7 × 1.5 mm ²	40°C	24 kg	IP 68	1.415	40 m ³ /h	8 m
SPF 3000-S3-50%*	3.2 kW	2.7 kW	400 V	50 Hz	5.4 A	3 × 16 A	7 × 1.5 mm ²	40°C	24 kg	IP 68	2.845	47 m ³ /h	16 m

* Definition of S3-pumps see page 101