

# Bathroom drain *Classic*

The compact drain with all-rounder qualities.

The *Classic* model is the all-rounder among our bathroom drains. Its compact size, lateral or vertical outlet and various installation options make it particularly versatile. The flow rate is 0.8 l/s.

### Modular design

As part of the modular system 100, the *Classic* can be adjusted any way required and can be combined with numerous accessories – for example, with the Multistop odour trap or a glued flange as a moisture seal.

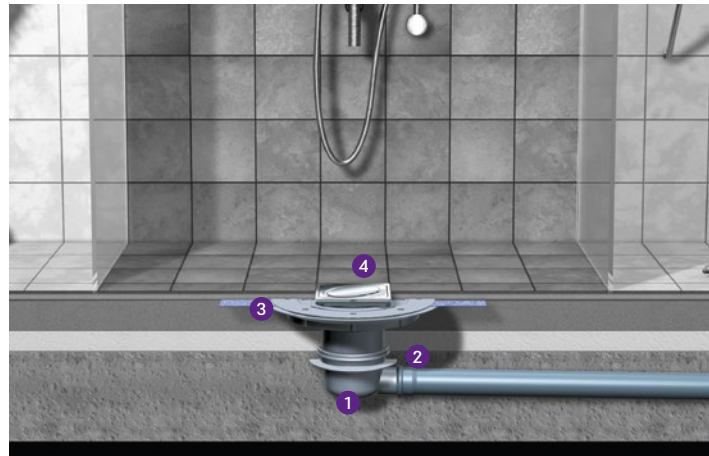

1 Drain 2 Outlet 3 Adhesive flange 4 Steel cover

## Bathroom drain *Classic* with *Variofix* shallow bed upper section



Type Tested and Monitored  
www.tuv.com  
ID 1111244461

EN 1253-1

Made in ABS, with removable odour trap, sealing water height 50 mm, with fixed lip seal. Drainage capacity 0.8 l/sec flow rate. Installation area 220 × 180 mm

With *Variofix* shallow bed upper section in ABS, with non-mounted waterproofing membrane according to EN 1253-1 and DIN 18534-1-W3-I for shallow bed sealing

### Cover:

Design cover *Oval* 120 × 120 mm and rim made of stainless steel AISI 304, for tile thicknesses 8 – 21 mm, class L 15;

standard slotted cover 95 × 95 mm made of stainless steel AISI 304, for tile thicknesses 6 – 14 mm, class K 3 or

slotted cover 138 × 138 mm and rim made of stainless steel AISI 304, for tile thicknesses 8 – 16 mm, class L 15



Illustration shows Art. no. 40 150.54 with *Lock & Lift* locking system

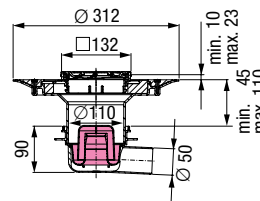

Illustration shows Art. no. 40 150.54

### Lateral outlet Vertical outlet

Outer diameter Ø (mm)	Art. no.	Art. no.
With design cover <i>Oval</i> with <i>Lock &amp; Lift</i> locking system		
Ø 50	40 150.54	40 250.54
Ø 75	40 170.54	40 270.54
With standard slotted cover		
Ø 50	40 150.50	40 250.50
Ø 75	40 170.50	40 270.50
With slotted cover		
Ø 50	40 150.51	40 250.51
Ø 75	40 170.51	40 270.51